

Jayco | 2025 Jay Feather Travel Trailer



JAY FEATHER

ADVENTURE IS CALLING

2+3
YEAR | YEAR
WARRANTY



VINTAGE FARMHOUSE

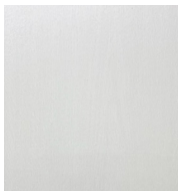

Main Wood



Accent Wood



Floor



Countertop



Main Fabric



Accent Fabric

19MRK

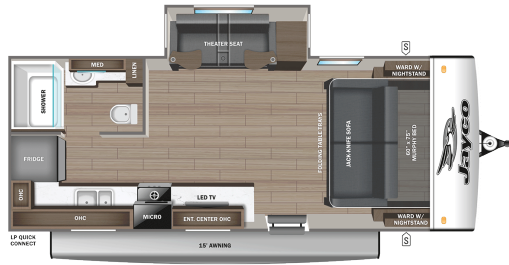

21MBH OPTION: B



21MML

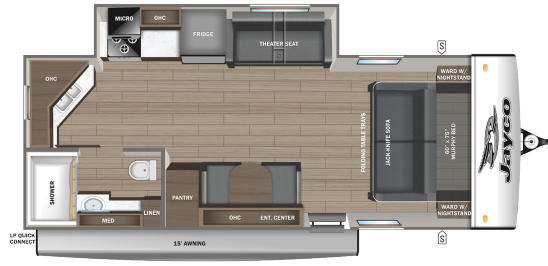

22RB OPTIONS: B, C

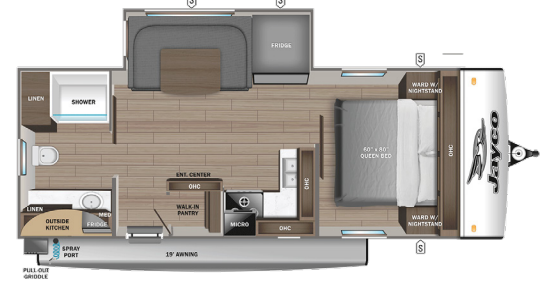

23RK OPTION: C



24BH OPTIONS: B, C

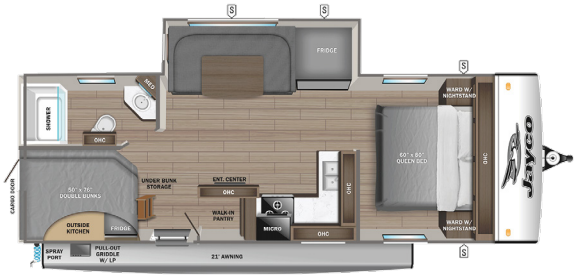

24RL OPTIONS: B, C

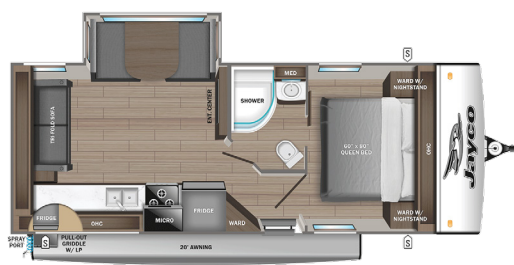

25RB OPTIONS: B, C, E



S STORAGE
MICRO MICROWAVE
OHC OVERHEAD CABINETS
FRIDGE REFRIGERATOR
WARD WARDROBE

OPTIONS

A Tri-fold Sofa **B** Theater Seat **C** King Bed **D** Table & Chairs **E** Mega Lounge

26FK OPTIONS: C, D, E

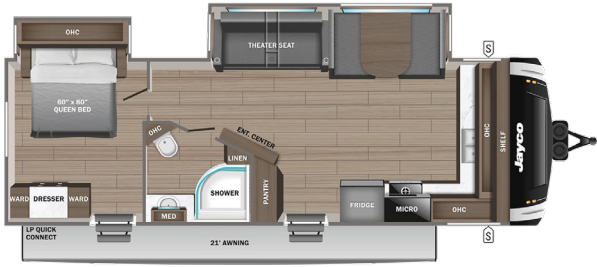

26RL OPTIONS: C, D



27BH OPTIONS: B, C, D, E



27MK OPTIONS: B, C, D, E

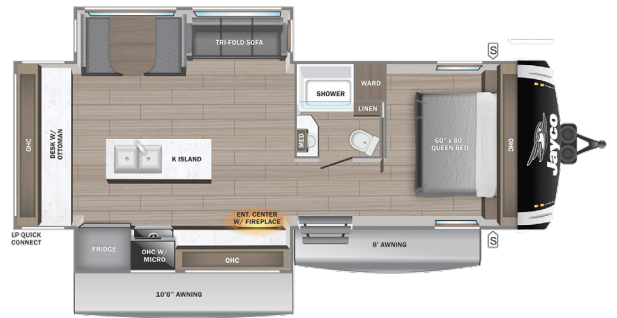

27RK OPTIONS: B, C, D, E

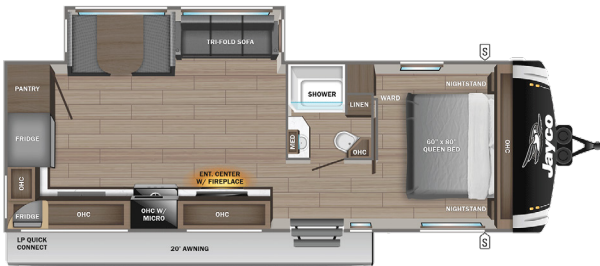

28RB OPTIONS: B, C, D, E



29BHB OPTIONS: B, C, D, E

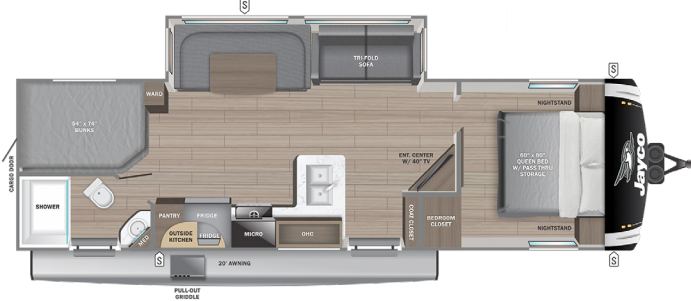

29QBH OPTIONS: B, C, D, E

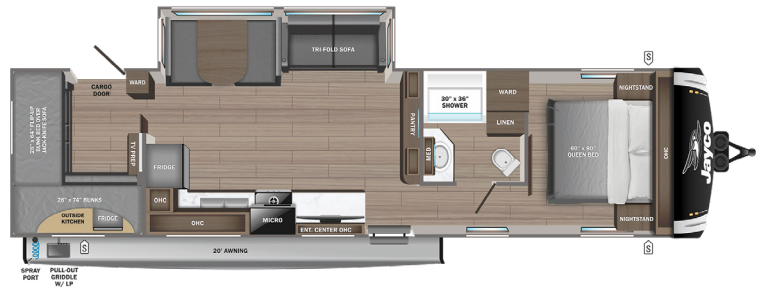

- STORAGE
- MICROWAVE
- OHC OVERHEAD CABINETS
- FRIDGE REFRIGERATOR
- WARD WARDROBE

OPTIONS

- A** Tri-fold Sofa
- B** Theater Seat
- C** King Bed
- D** Table & Chairs
- E** Mega Lounge

29RL OPTIONS: C, D, E

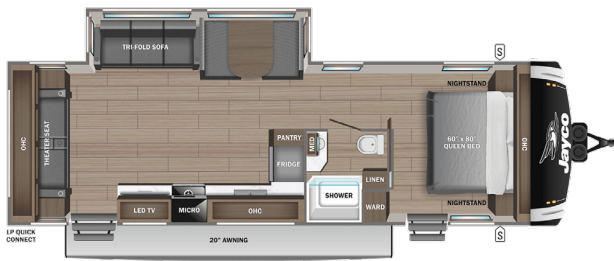

31BH OPTIONS: B, C, D, E

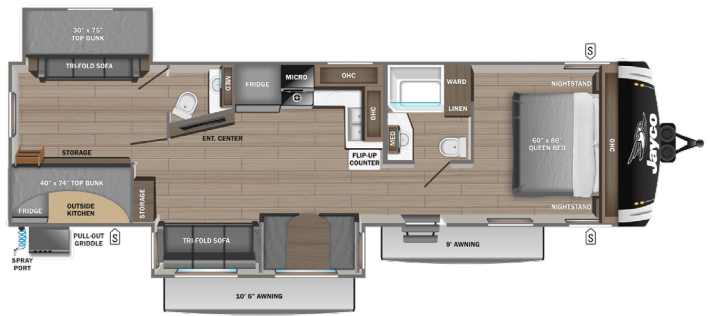

32QBH OPTIONS: B, C, D, E

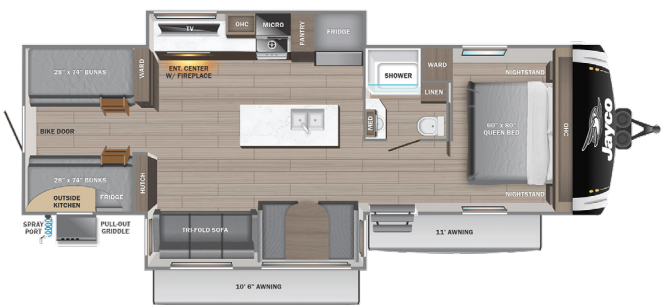

32RL OPTIONS: C, D, E



S STORAGE
MICRO MICROWAVE
OHC OVERHEAD CABINETS
FRIDGE REFRIGERATOR
WARD WARDROBE

OPTIONS

A Tri-fold Sofa **B** Theater Seat **C** King Bed **D** Table & Chairs **E** Mega Lounge

*Indicates split tanks

FLOORPLAN	EXTERIOR TRAVEL LENGTH	EXTERIOR WIDTH	EXTERIOR HEIGHT (WITH A/C)	INTERIOR HEIGHT	UNLOADED VEHICLE WEIGHT	DRY HITCH WEIGHT	GVWR	CARGO CARRYING CAPACITY	FRESH WATER CAPACITY (INCLUDING WATER HEATER)	GRAY WASTE WATER CAPACITY	BLACK WASTE WATER CAPACITY	SLEEPING CAPACITY
19MRK	23' 2"	8' 0"	10' 8"	6' 6"	4,960	565	6,400	1,440	55	38	30.5	2
21MBH	26' 8"	8' 0"	10' 9"	6' 6"	5,545	615	6,995	1,450	55	30.5	30.5	6-8
21MML	25' 5"	8' 0"	10' 8"	6' 6"	5,225	975	6,500	1,275	55	30	30	2
22RB	27' 2"	8' 0"	10' 9"	6' 6"	5,590	635	7,000	1,410	55	60*	34	3-4
23RK	28' 7"	8' 0"	10' 8"	6' 6"	5,930	720	7,400	1,470	55	60*	30	3-4
24BH	29' 8"	8' 0"	10' 8"	6' 6"	6,080	720	7,500	1,420	55	61*	30.5	6-8
24RL	28' 0"	8' 0"	10' 9"	6' 6"	5,670	675	7,000	1,330	55	30	30	4-6
25RB	30' 1"	8' 0"	10' 8"	6' 6"	6,150	800	7,500	1,350	55	60*	34	2-4
26FK	31' 9"	8' 0"	11' 0"	6' 6"	7,065	925	8,500	1,435	54	60*	30	2
26RL	31' 4"	8' 0"	10' 8"	6' 6"	6,300	700	7,600	1,300	55	30	30	2-4
27BH	32' 3"	8' 0"	11' 0"	6' 6"	6,660	820	8,200	1,540	55	76*	38	8-10
27MK	33' 3"	8' 0"	10' 11"	6' 6"	7,305	800	8,850	1,545	55	71*	30.5	2-4
27RK	32' 4"	8' 0"	10' 11"	6' 6"	6,655	890	8,200	1,545	55	60*	30	4-6
28RB	33' 1"	8' 0"	10' 11"	6' 6"	6,770	815	8,400	1,630	55	60*	30	4-6
29BHB	34' 0"	8' 0"	10' 10"	6' 6"	7,000	715	8,500	1,500	55	68.5*	30.5	8-10
29QBH	35' 7"	8' 0"	10' 10"	6' 6"	7,330	958	8,850	1,520	55	61*	30.5	4-7
29RL	35' 4"	8' 0"	11' 0"	6' 6"	7,130	950	8,650	1,520	54	60*	40	4-6
31BH	37' 2"	8' 0"	11' 0"	6' 6"	8,010	1,085	9,600	1,590	55	70*	60*	5-7
32QBH	37' 8"	8' 0"	11' 0"	6' 6"	8,000	1,035	9,600	1,600	55	57	30.5	6-8
32RL	35' 7"	8' 0"	11' 0"	6' 6"	7,580	980	9,000	1,420	55	71*	30.5	2-4

Some specs at the time of print may include estimates. For the most updated information, please visit Jayco.com

STANDARDS & OPTIONS

EXTERIOR

1.5 in. fresh water drain valve
18 in. rear roof ladder - factory installed
2 in. Stronghold VBL™ floor with 2 lb. density foam
Stronghold VBL™ walls with double-sided Azdel composite (sidewalls, rear walls and slide out boxes)
Aerodynamic, rounded front profile with aluminum framing
American-made Norco Z-frame with integrated A-frame
Automotive-style aluminum rims
Battery quick-disconnect
Dark-tinted safety-glass windows
Front diamond plating
Front molded decorative cap
Galvanized steel and impact resistant wheel wells
Keyed-Alike™ locking system
Magnum Truss™ Roof System
Marine grade exterior speakers
Outdoor camp kitchen with galvanized steel bases (select models)
PVC roofing membrane (limited lifetime warranty)
Swing-out entry door assist handle
Exterior TV Hookups 120V and cable

INTERIOR

4 in. high-density dinette cushions with vinyl backing
4 in. soft-touch bunk mats (select models)
60 x 80 in. residential queen beds (60 x 76 in. in Murphy bed models)
75 lb. full extension drawer guides
Bathroom skylight
Decorative backsplash
Decorative roller shades with reflective barrier
Directional and closeable A/C vents
Gas-strutted under bed storage (most models)
Handcrafted, hardwood door/drawer fronts
Hidden-hinged cabinet doors
High output auto-ignition LP gas furnace

LED lighting throughout
Plywood dinette, bed, bunk and shower/tub bases
Powered roof vents in bathroom and main bedroom (most models)
Residential style seamless countertops throughout
Residential vinyl flooring throughout
Screwed and glued cabinet stiles
USB charging ports (multiple locations throughout)

CUSTOMER VALUE PACKAGE (MANDATORY)

Radial tires with self-adjusting electric brakes
13,500 BTU Mach Quiet Series A/C
20 lb. LP gas bottles with auto-regulator and ABS cover
55 gal. fresh water tank
Automotive-style aluminum rims
Black tank flush
Detachable power cord
Inverter pre-wire (2 bedroom nightstand outlets, main TV and outlet for outside kitchen fridge)
Max-length power awning with LED light
On-demand 60,000 BTU water heater
Power tongue jack
Rock Solid Stabilizer System
Side and rear back-up camera prep
Under-mount spare tire

JAY SPORT PACKAGE (MANDATORY)

11 cu. ft. 12V fridge
Tire Pressure Monitoring (App based)
Climate Shield (zero to 100 degree tested weather insulation package)
Front slam-latch baggage doors
Invision appliance package
LCI Solid Step fold-down aluminum tread steps on main entry door
LED smart TV
MAXXAIR® power roof vent (main living area)

Modern graphics package with dual-colored sidewall
Overlander 1 Solar Package: (1) 200W solar panel and 30-amp digital controller
Porcelain foot-flush toilet
Stainless steel kitchen & bathroom sink

OPTIONS

120V heated tank pads
15,000 BTU Mach Quiet Series A/C
2nd A/C (select models)
Front molded decorative cap
Rear 2 in. receiver
30 lb. LP gas bottles with auto-regulator
50-amp service (N/A on 19MRK, 21MML, 21MBH)
72 x 80 in. King bed (select models)
Electric fireplace (N/A 21MBH, 21MML, 23RK) (Standard on 26FK, 27MK, 27RK, 31BH, 32QBH, 32RL)
Freestanding table and 4 chairs (select models)
JAYCOMMAND® Smart RV System (select models)
Mega-lounger - Theater seating with tri-fold sofa and party trays (select models)
Overlander 2 Solar Package: (2) 200W solar panels, 30-amp digital controller and 1,800W inverter

Meet your Jayco Dealer



Scan QR code for specification definitions

Some specs at the time of print may include estimates. For the most updated information, please visit [Jayco.com](https://www.jayco.com)

Jayco, Inc. | P.O. Box 460 | Middlebury, IN 46540

See dealer for further information and prices. All information in this brochure and on www.jayco.com is the latest available at the time of publication approval. Jayco reserves the right to make changes and to discontinue models without notice or obligation. Photography may show optional equipment or props used for decoration purposes only. RVs built for sale in Canada may differ to conform to Canadian codes. JAYCO and the JAYCO BIRD IN FLIGHT are registered trademarks of Jayco, Inc. Printed in USA 11/24 ©2024 Jayco, Inc. 2032967



Jayco - Part of Jayco Family of Companies