

FREEDOM *Express*



Coachmen®
Recreational Vehicles
A division of Forest River, Inc.

FREEDOM TO EXPLORE
ULTRA LIGHT TRAVEL TRAILERS ♦ DEEP SLIDES ♦ TOY HAULERS ♦ EXPANDABLES

322 RLDS

Total Freedom - Ultra Light Selection

Escape from your busy life for a fun, hassle-free adventure with Freedom Express. These ultra light models are value packed with industry leading features. Most models come in three price points to fit any budget. Our 38" Deep Slide models offer expansive single, double and triple slide living areas. Storage and counter space are a top priority on all models. Choose from the industry's best bunk and rear lounge floorplans, plus Toy Hauler models.



Liberty and Maple Leaf Editions feature a Gel Coat Fiberglass cap.



Couples appreciate the comfortable **276 RKDS**. It's spacious, with 176 cu. ft. of interior storage, a 30" x 50" shower with a glass door, extended counter space, two convenient entrances and a wide awning that covers both doors. Shown in Java decor.





322 RLDS The Liberty Edition (Maple Leaf Edition in Canada) includes high end amenities usually reserved for travel trailers and fifth wheels costing thousands of dollars more. Family and friends will appreciate the extra amenities offered in this luxury upgrade including: LG solid surface counters, residential glass backsplash – even plush theater seating for kicking back on a rainy day, plus much more! Shown in Sunset decor.

DECOR

SUNSET

SLATE

JAVA



FREEDOM TO EXPLORE



320 BHDS *The family cook will love this open concept floorplan with an accented wood kitchen island for extra counter space, a deep basin sink and pull-out faucet, plus large storage drawers. The plush hide-a-bed sofa converts for extra sleeping space. Shown in Slate decor.*



320 BHDS *This bunkhouse model is loaded with storage. The large entry closet provides plenty of shelving for shoes, extra gear and a waste basket.*



FREEDOM VALUE PACKAGE (Required)

- ♦ Aluminum Wheels
- ♦ Spare Tire Kit
- ♦ Detachable Power Cord
- ♦ Power Awning
- ♦ Tinted Safety Glass Windows
- ♦ Front Diamond Plate
- ♦ TV & Radio Antenna with Booster
- ♦ EZ Lube Axles
- ♦ Spread Axle Design*
- ♦ Black Metal Skirting
- ♦ Matching Fenders
- ♦ Heated Enclosed Underbelly, 33/33 Holding Tanks*
- ♦ 49 Gallon Fresh Water Holding Tank*
- ♦ Folding Entry Assist Handle
- ♦ Exterior Shower Station
- ♦ LP Port for Gas Grill hook-up
- ♦ Winterize Ready Kit
- ♦ Black Tank Flush
- ♦ 2 Exterior Speakers, 4 Interior Speakers
- ♦ Ducted Furnace*
- ♦ Ducted Ceiling Air Conditioning (25' and above)
- ♦ AM/FM/CD/DVD/Bluetooth
- ♦ 24", 32" or 39" LED TV
- ♦ Satellite Ready
- ♦ LED Interior Lighting Throughout
- ♦ Night Shades Throughout
- ♦ Congoleum Designer Carefree Flooring
- ♦ Mortise and Tenon Cabinet Doors
- ♦ Stonecast Sink
- ♦ Sink Covers
- ♦ Dual Setting LED Strip Light above Kitchen Sink
- ♦ Microwave
- ♦ Oven with 3 Burner Cooktop
- ♦ 6 Cu. Ft. Two Door Refrigerator
- ♦ Silverware Drawer (select models)
- ♦ 60" x 80" Queen Bed
- ♦ LED Swivel Crystal Reading/Night Light - Bedroom
- ♦ Electronic Charging Station
- ♦ Skylight in Bath
- ♦ RVIA
- ♦ Black Tufcoat Skirt Metal
- ♦ Slam Latch Baggage Doors on Pass Through Storage
- ♦ Enclosed and Heated Gate Valves
- ♦ Power Tongue Jack
- ♦ RG6 TV Hook-up Camp Side
- ♦ Camp Side Security Light
- ♦ Central Control Panel for Switches and Gauges
- ♦ Raised Panel Glazed Independence Maple Doors
- ♦ Raised Panel Refer Inserts
- ♦ Solid Surface Kitchen Countertop Undermount Stonecast Sink with Sink Covers
- ♦ Designer Eyebrow with LED Lights over Kitchen Cabinet
- ♦ Silver Reeded Glass Backsplash
- ♦ Pull Out Sprayer Faucet
- ♦ Hide-A-Bed Sofa
- ♦ Hinged Door, Slider Drawer, and Pots and Pans Drawer Under Dinette
- ♦ Freedom Sky View Window with Pleated Shade over Dinette
- ♦ Designer Bedspread with matching Pillows
- ♦ Porcelain Toilet with Foot Flush
- ♦ Three Upgrade Décors - Java, Slate, Sunset

OPTIONAL PREMIER PACKAGE

Liberty and Maple Leaf Editions only

- ♦ Electric Fireplace with Wrought Iron LED Lit Translucent Slate
- ♦ Large 8 Cu. Ft. Refrigerator
- ♦ 3" Recessed LED Lighting over Dinette
- ♦ Wrought Iron Ceiling Decoration with LED Lit Translucent Slate
- ♦ 4" LED Recessed Lights in living Area
- ♦ LED Rope Light at Awning, 12" LED Strip Light Entry Step and Pass-through Storage (N/A 293 RLDS & 297 RLDS)
- ♦ Durable 24" x 48" Resin Outdoor Table

OPTIONS

- ♦ 15,000 BTU A/C
- ♦ 50 Amp Service with Second A/C Prep
- ♦ Push-button Power Stabilizer Jacks (25' and above)
- ♦ Coleman Slide-Out High Output Grill (Select models)
- ♦ Recliners
- ♦ Frameless Windows
- ♦ Canadian Compliance

LIBERTY/MAPLE LEAF EDITION PACKAGE (Upgrade)

- ♦ Gel Coated Fiberglass Cap with LED Hitch and Marker Lights
- ♦ Front Rock Guard on Cap
- ♦ Special Liberty/Maple Leaf Edition Graphics

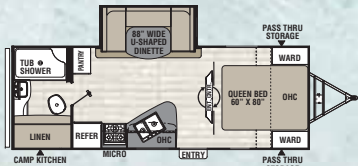

231 RBSLE ♦ Exterior Length 26' 10"

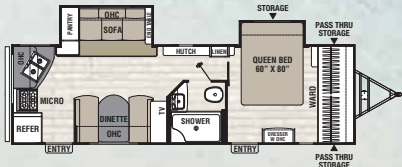

276 RKSLE ♦ Exterior Length 31' 6"

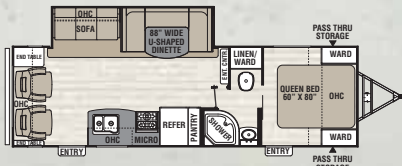

281 RLSLE ♦ Exterior Length 31' 8"

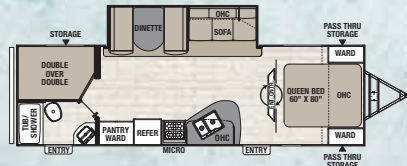

282 BHSLE ♦ Exterior Length 31' 11"

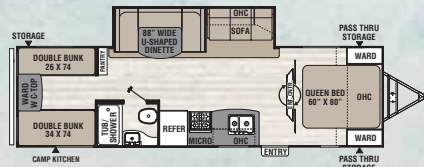

292 BHSLE ♦ Exterior Length 33' 5"

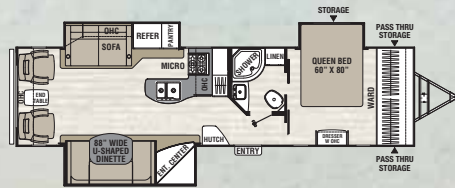

293 RLSLE ♦ Exterior Length 35' 11"

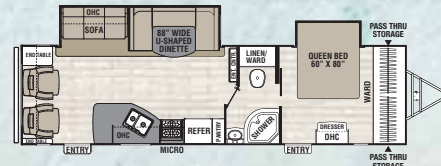

297 RLSLE ♦ Exterior Length 35' 2"

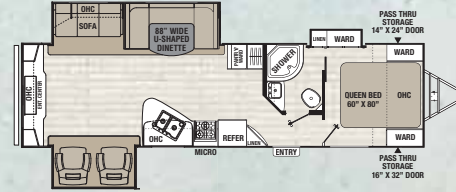

298 RLSLE ♦ Exterior Length 35' 2"

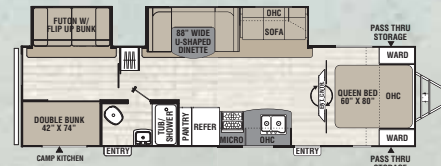

310 BHSLE ♦ Exterior Length 35' 7"

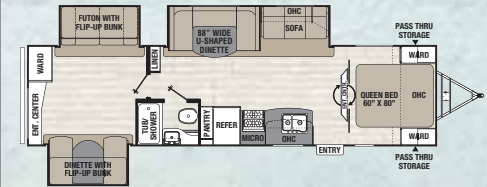

312 BHSLE ♦ Exterior Length 36' 9"

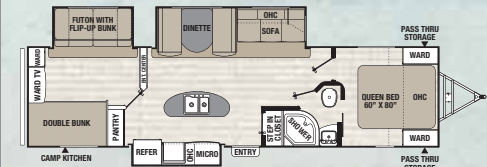

320 BHSLE ♦ Exterior Length 36' 11"

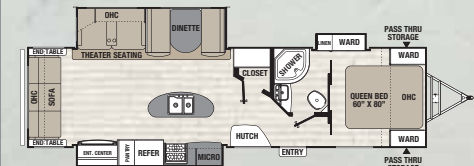

322 RLSLE ♦ Exterior Length 35' 11"

Deep Slides	231 RBSLE	276 RKSLE	281 RLSLE	282 BHSLE	292 BHSLE	293 RLSLE	297 RLSLE	298 RLSLE	310 BHSLE	312 BHSLE	320 BHSLE	322 RLSLE
UVW*	5,228	6,325	5,963	6,165	6,344	7,811	7,116	7,493	7,414	7,739	7,912	7,409
Hitch Weight	645	791	712	819	747	985	975	66	937	983	879	954
Carrying Capacity	2,230	1,233	1,595	1,498	1,214	2,047	2,642	2,315	2,444	2,717	2,746	2,349
Exterior Length (Bumper to Hitch)	26' 10"	31' 6"	31' 8"	31' 11"	33' 5"	35' 11"	35' 2"	35' 2"	35' 7"	36' 9"	36' 11"	35' 11"
Exterior Height (Includes A/C)	10' 9"	10' 9"	10' 9"	10' 9"	10' 7"	11' 2"	11'	11'	11'	11' 2"	11' 2"	11' 2"
Interior Height (Coach)	81"	81"	81"	81"	81"	81"	81"	81"	81"	81"	81"	81"
Awning Length	14'	20'	18'	18'	18'	12' and 10'	20'	18'	18'	18'	20'	20'
Fresh/Grey/Waste Water Capacity (gal.)	49/33/33	49/66/33	49/33/33	49/33/33	49/33/33	49/33/33	49/33/33	49/33/33	49/33/33	49/33/33	49/66/33	49/33/33
Tire Size ST205/75R14C	ST205/75R14C	ST205/75R14C	ST205/75R14C	ST205/75R14C	ST205/75R14C	ST225/75R15D	ST225/75R15D	ST225/75R15D	ST225/75R15D	ST225/75R15D	ST225/75R15D	ST225/75R15D

*Unloaded vehicle weights do not include options. Please refer to back cover for definitions of chart descriptions.



- ♦ 50% Lighter than wood
- ♦ No rot, mold or water damage
- ♦ R-2 thermal insulation
- ♦ Odorless, no formaldehyde
- ♦ Sound & energy absorbing
- ♦ Impact & puncture resistant
- ♦ Made in USA



FREEDOM TO EXPLORE



257 BHS

Find Your Freedom – Ultra Lightweight Towability & Convenience

Lightweight Freedom Express has been designed for easy towing with today's half ton trucks, cross overs and mid-sized SUVs. All tanks are located under the floor to lower the center of gravity for increased storage capacity and improved handling.



257 BHS This stylish, well-planned living area has oversized windows for plenty of natural light, an upgraded entertainment center and expanded U-shape dinette seating. Shown in Chestnut decor.



The **257 BHS** has double bunk beds with storage below, a wardrobe and a pantry to hold all of your camping necessities. Shown in Chestnut decor.



192 RBS This very lightweight, open floorplan can easily be towed by smaller SUVs and is big on comfort with contemporary appliances and convenient amenities for enjoyable weekends. This model is equipped with two tables, one indoor/outdoor table from the entertainment package (above) and a seamless countertop table that is stored under the bed for easy access. Shown in Cashmere decor.

DECOR

SANDSTONE



CHESTNUT

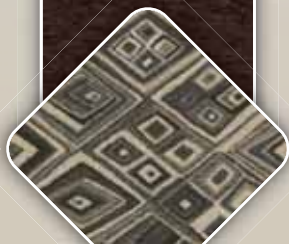

CASHMERE



FREEDOM TO EXPLORE



229 TBS features a 60" x 80" full walk around queen bed, impressive master bedroom storage, spacious counters and a second entry door for convenience. Shown in Sandstone decor.



FREEDOM TO EXPLORE

FREEDOM
Express



The 30' 229 TBS is a full size travel trailer with a complete kitchen, bathroom, triple bunk beds and an entertainment center that can be comfortably viewed from the Master bedroom. Shown in Sandstone decor.



229 TBS These triple bunks fold up for additional storage - enough space for bikes! Plus, there's additional storage at the end of each bunk so everyone has a place for their gear.

The Ultimate in Towability

Stable-Ryd® Suspension

- ◆ Spread axle improves weight distribution.
- ◆ Wide track axles provide a wider, more secure stance on the road.
- ◆ Spread axle design allows us to reduce the tongue weight for optimum performance.
- ◆ Spread axle design reduces sway caused by crosswinds.

Aerodynamic

- ◆ Aerodynamic front profile (Cuts through the air)
- ◆ Enclosed underbelly reduces turbulence/drag. (Select models)

Lightweight

- ◆ Laminated sidewalls and floor
- ◆ Azdel behind the fiberglass
- ◆ Bow trusses aluminum and wood
- ◆ Rod & angle crossmembers in frame
- ◆ All tanks mounted under floor to lower center of gravity and improve interior storage.



Freedom Express is TRA gold level rated. As a certified green RV, Freedom Express utilizes effective production techniques in combination with healthy materials, plus efficient usage of energy and water to produce a high quality RV with less environmental impact.



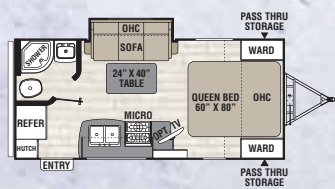

192 RBS ♦ Exterior Length 22' 6"

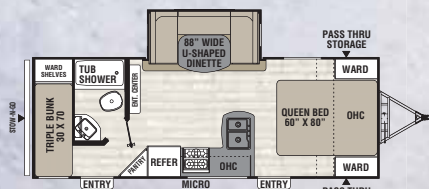

229 TBS ♦ Exterior Length 26' 9"

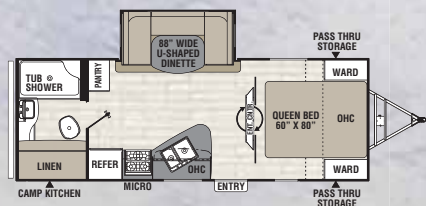

231 RBDS ♦ Exterior Length 26' 10"

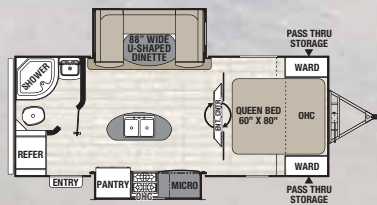

233 RBS ♦ Exterior Length 24' 11"

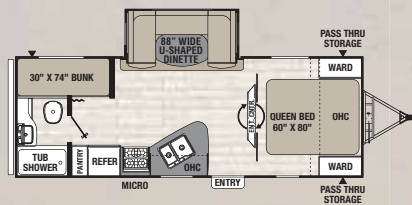

236 BHS ♦ Exterior Length 27' 3"

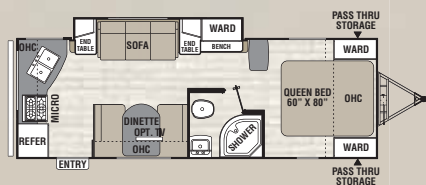

246 RKS ♦ Exterior Length 28' 3"

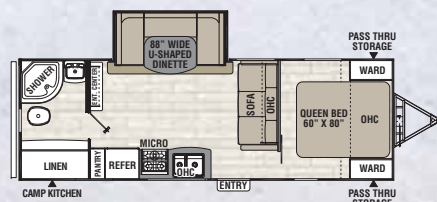

248 RBS ♦ Exterior Length 28' 11"

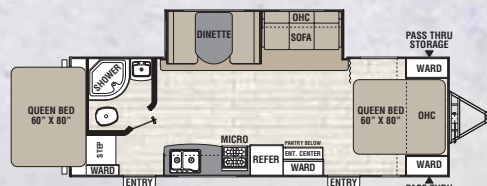

254 DSX ♦ Exterior Length 29' 7"

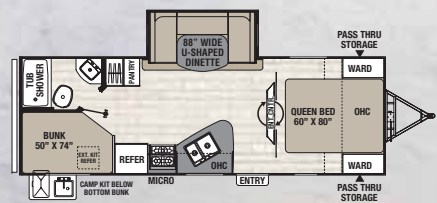

257 BHS ♦ Exterior Length 28' 7"

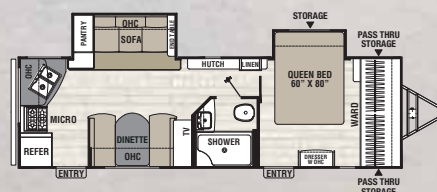

276 RKDS ♦ Exterior Length 31' 6"

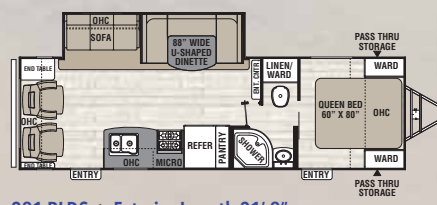

281 RLDS ♦ Exterior Length 31' 8"

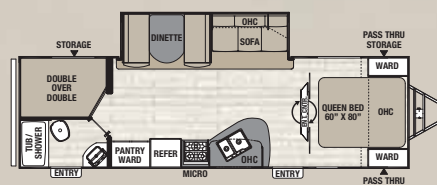

282 BHDS ♦ Exterior Length 31' 11"

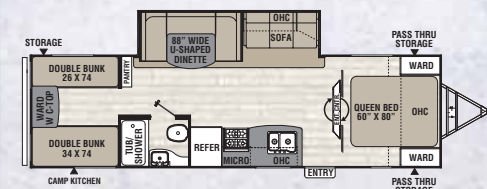

292 BHDS ♦ Exterior Length 33' 5"

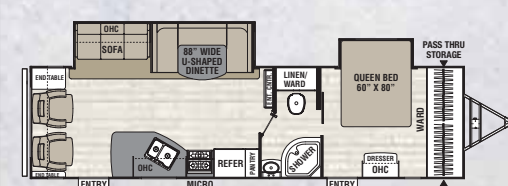

297 RLDS ♦ Exterior Length 35' 2"

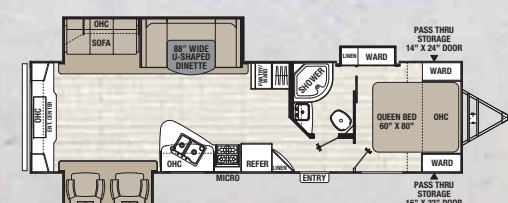

298 REDS ♦ Exterior Length 35' 2"

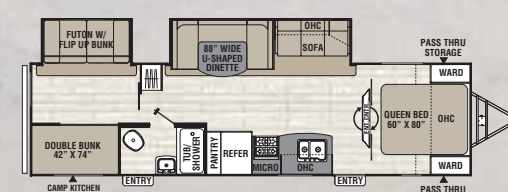

310 BHDS ♦ Exterior Length 35' 7"

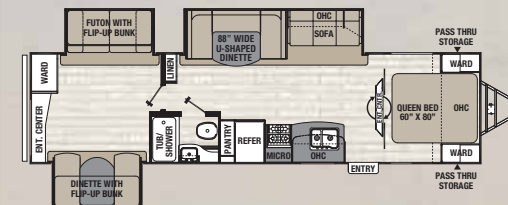

312 BHDS ♦ Exterior Length 36' 9"

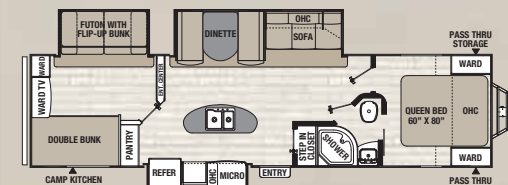

320 BHDS ♦ Exterior Length 36' 11"

FREEDOM VALUE PACKAGE (Required)

- ◆ Aluminum Wheels
- ◆ Spare Tire Kit
- ◆ Detachable Power Cord
- ◆ Power Awning
- ◆ Tinted Safety Glass Windows
- ◆ Front Diamond Plate
- ◆ TV & Radio Antenna with Booster
- ◆ EZ Lube Axles
- ◆ Spread Axle Design*
- ◆ Black Metal Skirting
- ◆ Matching Fenders
- ◆ Heated Enclosed Underbelly, 33/33 Holding Tanks*
- ◆ 49 Gallon Fresh Water Holding Tank*
- ◆ Folding Entry Assist Handle
- ◆ Exterior Shower Station
- ◆ LP Port for Gas Grill hook-up
- ◆ Winterize Ready Kit
- ◆ Black Tank Flush
- ◆ 2 Exterior Speakers, 4 Interior Speakers
- ◆ Ducted Furnace*
- ◆ Ducted Ceiling Air Conditioning (25' and above)
- ◆ AM/FM/CD/DVD/Bluetooth
- ◆ 24", 32" or 39" LED TV
- ◆ Satellite Ready
- ◆ LED Interior Lighting Throughout
- ◆ Night Shades Throughout
- ◆ Congoleum Designer Carefree Flooring
- ◆ Mortise and Tenon Cabinet Doors
- ◆ Stonecast Sink
- ◆ Sink Covers
- ◆ Dual Setting LED Strip Light above Kitchen Sink
- ◆ Microwave
- ◆ Oven with 3 Burner Cooktop
- ◆ 6 Cu. Ft. Two Door Refrigerator
- ◆ Silverware Drawer (select models)
- ◆ 60" x 80" Queen Bed
- ◆ LED Swivel Crystal Reading/Night Light - Bedroom
- ◆ Electronic Charging Station
- ◆ Skylight in Bath
- ◆ RVIA

Freedom Express	192 RBS	229 TBS	231 RBDS	233 RBS	236 BHS	246 RKS	248 RBS	254 DSX	257 BHS
UVW*	3,810	4,993	5,034	4,746	4,957	4,660	5,367	5,448	5,223
Hitch Weight	392	689	585	635	634	500	705	762	667
Carrying Capacity	2,048	1,965	2,424	2,212	2,001	2,298	2,091	2,010	2,235
Exterior Length (Bumper to Hitch)	22' 6"	26' 9"	26' 10"	24' 11"	27' 3"	28' 3"	28' 11"	29' 7"	28' 7"
Exterior Height (Includes A/C)	10' 3"	10' 9"	10' 9"	10' 9"	10' 9"	10' 4"	10' 9"	10' 9"	10' 9"
Interior Height (Coach)	81"	81"	81"	81"	81"	81"	81"	81"	81"
Awning Length	14'	16'	14'	16'	18'	18'	16'	18'1	20'
Fresh/Grey/Waste Water Capacity (gal.)	36/30/30	49/33/33	49/33/33	36/30/30	49/33/33	49/33/33	49/33/33	49/33/33	49/33/33
Tire Size	ST205/75R14C	ST205/75R14C	ST205/75R14C	ST205/75R14C	ST205/75R14C	ST205/75R14C	ST205/75R14C	ST205/75R14C	ST205/75R14C

*Unloaded vehicle weights do not include options. Please refer to back cover for definitions of chart descriptions.

Deep Slides	276 RKDS	281 RLDS	282 BHDS	292 BHDS	297 RLDS	298 REDS	310 BHDS	312 BHDS	320 BHDS
UVW*	6,049	5,600	5,866	6,058	6,805	7,060	7,205	7,614	7,694
Hitch Weight	730	740	737	740	898	832	865	870	820
Carrying Capacity	1,509	1,958	1,792	1,777	2,953	2,798	2,653	2,844	2,964
Exterior Length (Bumper to Hitch)	31' 6"	31' 8"	31' 11"	33' 5"	35' 2"	35' 2"	35' 7"	36' 9"	36' 11"
Exterior Height (Includes A/C)	10' 9"	10' 9"	10' 9"	10' 9"	11'	11'	11'	11' 2"	11' 2"
Interior Height (Coach)	81"	81"	81"	81"	81"	81"	81"	81"	81"
Awning Length	20	18'	18'	18'	20'	18'	18'	18'	20'
Fresh/Grey/Waste Water Capacity (gal.)	49/66/33	49/33/33	49/33/33	49/33/33	49/33/33	49/33/33	49/33/33	49/33/33	49/66/33
Tire Size	ST205/75R14C	ST205/75R14C	ST205/75R14C	ST205/75R14C	ST225/75R15D	ST225/75R15D	ST225/75R15D	ST225/75R15D	ST225/75R15D

*Unloaded vehicle weights do not include options. Please refer to back cover for definitions of chart descriptions.

ENTERTAINMENT PACKAGE

Optional upgrade on standard Freedom Express models

- ◆ LED 4" Recessed Lights in Living Area
- ◆ White LED Awning Light
- ◆ 12" LED Step Light
- ◆ LED Light Strip in Pass-through Storage
- ◆ 24" x 48" Resin Outdoor Table

OPTIONS

- 15,000 BTU A/C
- 50 Amp Service with Second A/C Prep
- Push-button Power Stabilizer Jacks (25' and above)
- Power Tongue Jack
- Coleman Slide-Out High Output Grill (Select models)
- Hide-A-Bed (Deep slides only)
- Frameless Windows
- Canadian Compliance

*Not available on models under 25'



- ◆ 50% Lighter than wood
- ◆ No rot, mold or water damage
- ◆ R-2 thermal insulation
- ◆ Odorless, no formaldehyde
- ◆ Sound & energy absorbing
- ◆ Impact & puncture resistant
- ◆ Made in USA



FREEDOM TO EXPLORE

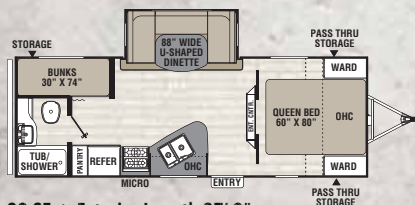

23 SE ♦ Exterior Length 27' 3"

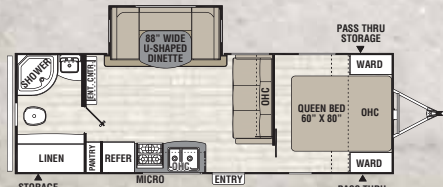

24 SE ♦ Exterior Length 28' 11"

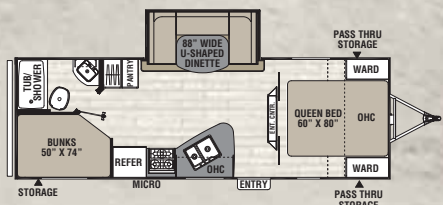

25 SE

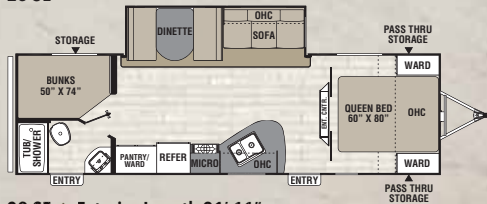

28 SE ♦ Exterior Length 31' 11"

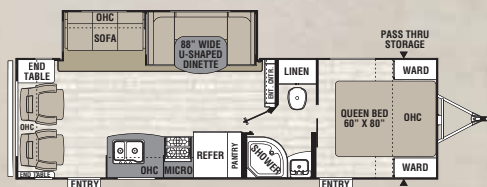

28.1 SE

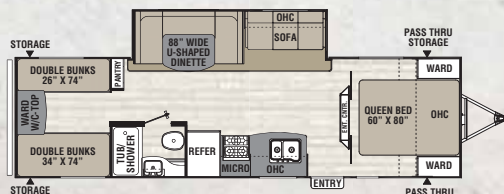

29 SE ♦ Exterior Length 33' 5"

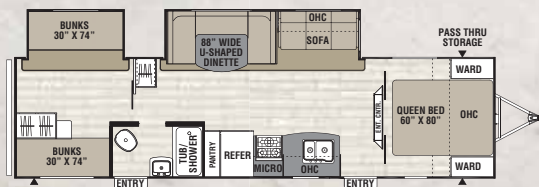

31 SE ♦ Exterior Length 35' 7"

SPECIAL EDITION PACKAGE

- ♦ Radial Tires with Silver Steel Wheels
- ♦ Spare Tire
- ♦ Black Fenders with Black Skirt Metal
- ♦ Detachable Power Cord
- ♦ Power Awning
- ♦ Tinted Safety Glass Windows
- ♦ Front Diamond Plate
- ♦ TV and Radio Antenna with Booster
- ♦ Super Lube Axles
- ♦ Heated/Enclosed Underbelly
- ♦ 33/33 Gal Grey, Black Holding Tank
- ♦ 49 Gal Fresh Water Tank
- ♦ Folding Entry Assist Handle
- ♦ Two Exterior Speakers
- ♦ AM/FM/Bluetooth Stereo
- ♦ Two Interior Speakers
- ♦ Ducted AC
- ♦ Ducted Furnace
- ♦ 6 Gal DSI Gas/Electric Water Heater
- ♦ LED Interior Lighting
- ♦ Mortise and Tenon Cabinet Door
- ♦ Congoleum Diamond Flooring
- ♦ Night Shades
- ♦ Microwave
- ♦ Oven with 3-Burner Cooktop
- ♦ 6 Cu. Ft. Two-door Refrigerator
- ♦ Silverware Drawer
- ♦ Double Basin Sink
- ♦ Bath Skylight
- ♦ 60" x 80" Queen Mattress with Two-tone Bedspread.



28 SE This family-friendly model includes easy access, double-over-double bunks, plenty of counter space, solid master bedroom doors for privacy, and two convenient entrances. Shown in Platinum decor.



DECOR

PLATINUM

Special Edition Packages

Enjoy all the comforts of home! Freedom Express has combined our most popular features to create a selection of value package models. They come complete with private master bedrooms, plenty of additional sleeping areas, seamless kitchen counters, and entertainment towers.

Freedom Express Special Editions	23 SE	24 SE	25 SE	28 SE	28.1 SE	29 SE	31 SE
UVW	4,885	5,048	TBD	5,564	TBD	5,598	6,726
Hitch Weight	588	652	TBD	585	TBD	639	704
Carrying Capacity	2,073	2,410	TBD	1,894	TBD	1,960	2,732
Exterior Length	27' 3"	28' 11"	TBD	31' 11"	TBD	33' 5"	35' 7"
Exterior Height	10' 9"	10' 9"	TBD	10' 9"	TBD	10' 9"	11'
Interior Height	81"	81"	TBD	81"	TBD	81"	81"
Awning Length	16'	16'	TBD	16'	TBD	16'	16'
Fresh/Grey/Waste Water Capacity (gal.)	49/33/33	49/33/33	TBD	49/33/33	TBD	49/33/33	49/33/33
Tire Size	ST205/75R14C	ST205/75R14C	TBD	ST205/75R14C	TBD	ST205/75R14C	ST225/75R15D

*Unloaded vehicle weights do not include options. Please refer to back cover for definitions of chart descriptions.



Toy Haulers

Whether you're hauling mini-bikes or motocross, four wheelers or Fat Boys, there's a Freedom Express Toy Hauler for you. The 271BL has a front walk-around queen bed, large bathroom with abundant storage and a 10' open garage to haul all of your toys. The Deep Slide 301BLDS has a 10' enclosed garage with a slider patio door. Both models have raised roof lines and a beavertail ramp transition.

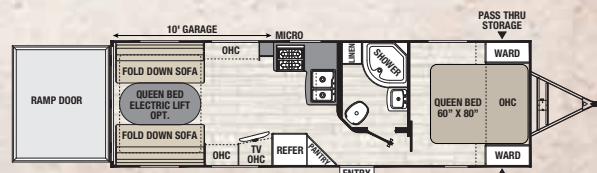

271 BL ♦ Exterior Length 30' 11"

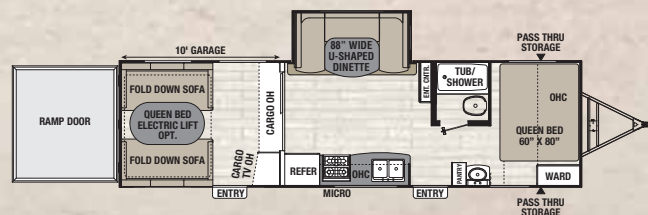

301 BLDS ♦ Exterior Length 33' 7"

Freedom Express Blast	271 BL	301 BLDS	301 BLDSLE
UVW	5,766	6,779	6,953
Hitch Weight	799	901	953
Carrying Capacity	3,192	3,079	2,905
Exterior Length (Bumper to Hitch)	30' 11"	33' 7"	33' 7"
Exterior Height (Includes A/C)	11' 9"	11' 10"	11' 10"
Interior Height (Coach)	90"	90"	90"
Awning Length	20'	18'	18'
Fresh/Grey/Waste Water Capacity (gal.)	98/33/33	98/33/33	98/33/33
Tire Size	ST225/75R15D	ST225/75R15D	ST225/75R15D

*Unloaded vehicle weights do not include options.
Please refer to back cover for definitions of chart descriptions.



271 BL has a glass shower, linen storage and an extended counter.



271 BL Find your Freedom! This large capacity, open garage is an outdoor enthusiast's home base. Shown in Chestnut decor.

BLAST TOYHAULER FEATURES

- ◆ Frame Mounted Tie-Down D-Rings In Floor
- ◆ Adjustable High/Low Fresh Air Vents
- ◆ Zippered Roll-up Screen Wall with Privacy Panels at Ramp Door
- ◆ Two Jackknife Sofas In Cargo Area
- ◆ Large Indoor/Outdoor folding Table
- ◆ Raised Roof Line - 90" Interior Cargo Height
- ◆ Beavertail Ramp Transition
- ◆ Sliding Patio Door Between Cargo and Living Areas (301 BLDS Only)
- ◆ Helmet/Gear Storage in Cargo Area
- ◆ Hinge Mounted Spring Assist Ramp Door System
- ◆ Integrated Bar and Latch Locking System on Ramp Door
- ◆ A-Frame Mounted Generator/Storage Rack (N/A on Liberty/Maple Leaf Editions)



271 BL has a private a 60" x 80" walk around bed in the private Master bedroom and plenty of storage.



271 BL This versatile, lightweight 10' open garage model is perfect for taking your show on the road.

301 BLDS has a sliding glass door for two versatile living areas. Shown in Chestnut decor.





23 TQX Cable Support Tent Ends - 1000# Capacity

Expandables

Pack all the livability of a 28'-33' travel trailer into the towability (and price) of a 21'-23' trailer. Freedom Express Expandables are easy to tow and come with the Secure-Lok tent system which eliminates the hassle of Velcro or bungees, making set-up and tear-down a snap - even for one person.

Freedom Express Expandables	21 TQX	22 DSX	23 TQX
UVW*	3,610	4,410	4,665
Hitch Weight	430	550	635
Carrying Capacity	2,148	2,548	2,293
Exterior Length (Bumper to Hitch)	22' 7"	22' 2"	24' 3"
Exterior Height (Includes A/C)	10' 3"	10' 9"	10' 9"
Interior Height (Coach)	81"	81"	81"
Awning Length	14'	16'	18'
Fresh/Grey/Waste Water Capacity (gal.)	36/30/30	36/30/30	36/30/30
Tire Size	ST205/75R14C	ST205/75R14C	ST205/75R14C

*Unloaded vehicle weights do not include options.

Please refer to back cover for definitions of chart descriptions.

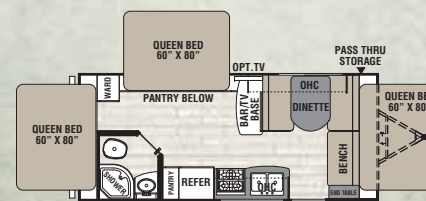

21 TQX ♦ Exterior Length 22' 7"

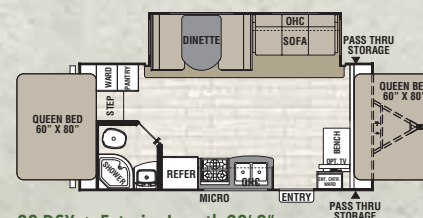

22 DSX ♦ Exterior Length 22' 2"

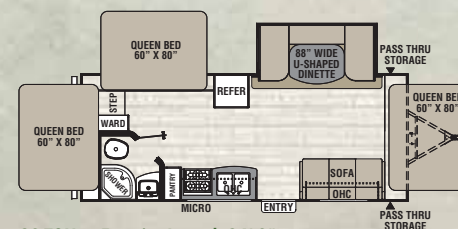

23 TQX ♦ Exterior Length 24' 3"

23 TQX Sleep up to 10 people with plenty of storage to hold everyone's camping supplies. This spacious expandable has a large living area and kitchen along with a fully enclosed bathroom and three 60" x 80" queen beds. Shown in Sandstone decor.



Lightweight Towability and Enhanced Aerodynamics

Freedom Express Ultra-Light travel trailers are ideal for half-ton tow vehicles and optimized fuel efficiency. Designed with fully laminated, aluminum framed walls and floor, Freedom Express travel trailers and hybrid expandables are incredibly lightweight and durable.

Freedom Express & Deep Slide Standard Features & Options FE = Freedom Express Ultra Lites ♦ LE = Liberty/Maple Leaf Edition Ultra Lites

	LE	FE	SE
INTERIOR & DÉCOR			
Independence Maple Hardwood Cabinet Doors and Drawer Faces	X	X	X
Furniture Grade, Pocket Drilled and Screwed Stile and Rail Cabinet Front Construction	X	X	X
Full Extension Roller Bearing Drawer Guides	X	X	X
Designer Hard Valance with Soft sided Window Treatments	X	X	X
Range Hood with 12V Exhaust and Light	X	X	X
Sealed/Seamless Countertops	X	X	X
Brushed Nickel Hardware	X	X	X
High-Rise Kitchen Faucet	X	X	X
60/40 Stonecast Composite Kitchen Sink	X	X	N/A
Silverware Drawer with Removable Tray (Select Models)	X	X	X
Jackknife Sofa	N/A	X	X
Dinette Storage Access Doors (No doors on Special Editions)	X	X	N/A
Accent Wall in Master Bedroom	X	X	X
Two Full-Length Mirrored Closets, Over-Bed Cabinets (Master)	X	X	X
Two Nightstands with 110V Outlets (Most models)	X	X	X
Storage Under Master Bed and Bunks (Select models)	X	X	X
Wooden Privacy Slider Doors to Master Suite			
In Place of Curtain or Accordion Door (Most models)	X	X	X
Vent in Master Bedroom	X	X	X

	LE	FE	SE
Entertainment Tower with Rotating TV for Bedroom Viewing (Select models) (N/A Special Editions)			
Exhaust Vent with Fan in Bathroom	X	X	X
Wood Medicine Cabinet with Bathroom Mirror and Cosmetics Shelf	X	X	X
Hi Rise Foot Flush Toilet	X	X	X
Interior Speakers with Selector Switch	X	X	X
55 Amp Power Converter	X	X	X
GFI Receptacles in Bathroom and Kitchen	X	X	X
LP Leak Alarm	X	X	X
Fire Extinguisher	X	X	X
Smoke and Carbon Dioxide Detector	X	X	X
Multiple Egress Windows with Screen and Prop Rod	X	X	X
EXTERIOR			
LP Bottle Cover w/Valve Access	X	X	X
60° A-frame	X	X	X
Dual Battery Rack	X	X	X
Insulated, Painted Radius Entry Door with Screen Door	X	X	X
Amber Patio Light	X	X	X
Water Heater Bypass	X	X	X
Heavy Duty Welded Safety Chains	X	X	X

	LE	FE	SE
Four-Wheel Electric Brakes			
Breakaway Safety Cable	X	X	X
Exterior GFI Outlet Near Awning	X	X	X
High-Capacity Roto-Cast Holding and Fresh Water Tanks	X	X	X
HappiJac Double Hat Rail, Rack and Pinion 12V Slide System (18" slides)	X	X	X
LCI Rack and Pinion 12V Slide System with Full Width Welded Ram (38" slides)	X	X	X
Schwintek Slide System (Some models)	X	X	N/A
CONSTRUCTION			
Azdel Composite (IPO Iuan behind fiberglass)	X	X	X
Smooth Fiberglass Exterior Skin	X	X	X
Powder E-Coated Steps and Axles	X	X	X
Floorplan Specific Cambered Frame Design	X	X	X
Double Wiper Seals on All Slideouts	X	X	X
STANDARD EXTRAS			
Green Certification	X	X	X
Seal Tech and Rain Bay Testing on Every Unit	X	X	X
One-Year Free Membership to Coachnet Roadside Assistance	X	X	X
One-Year Free Membership to Coachmen Owner's Association (C.O.A.)	X	X	X

Construction Features



- 3M breathable graphics
- Tinted, safety glass windows
- Crowned trusses
- Aluminum reinforced with 3/8" roof decking
- Di-Flex II TPO roofing
- Azdel Composite Panels
- Aerodynamic front profile
- Dual 20 lb. LP gas tanks
- Welded Aluminum structure, vacuum-bonded sidewalls and flooring
- Smooth exterior fiberglass skin
- Aluminum framed openings
- Fully enclosed, heated under belly (25' and above)
- Fully welded tubular aluminum floor structure
- HappiJac SureTrac™ rack and pinion slide systems
- Congoleum Designer Carefree Resilient Flooring
- Powder E-coated, welded I-beam frame
- Super-Lube® axle hubs
- Stable-Ryd® spread axle design (25' and above)
- Nitrogen filled radial tires



- ♦ 50% Lighter than wood
- ♦ No rot, mold or water damage
- ♦ R-2 thermal insulation
- ♦ Odorless, no formaldehyde
- ♦ Sound and energy absorbing
- ♦ Impact and puncture resistant
- ♦ Made in USA

FREEDOM Express

ULTRA LIGHT TRAVEL TRAILERS
DEEP SLIDES • TOY HAULERS
EXPANDABLES



Find out why Freedom Express has become one of the most demanded ultra light towable RV brands on the market today!



Coachmen Interactive Mobile Manuals

Download your Coachmen mobile app or visit our dynamic online manual to enhance your ownership experience. These interactive options provide incredible ease and insight into use, maintenance and enjoyment of your Coachmen product. Ranging from "How-To" videos, pictures and illustrations of various components, systems and features to fully searchable content and downloadable PDFs for individual component owner's manuals, answers are always just a click away.



Travel Easy™ Roadside Assistance

RVing is easier with Coachmen's Travel Easy™ Roadside Assistance provided FREE the first year of ownership to those who purchase a New Coachmen RV. Administered by Coach-Net, this service provides you with 24/7 operational, technical and emergency road service coverage. Also included is towing, fuel delivery, jump starts, lockout service, tire changes, mobile mechanic and unlimited technical assistance. Anywhere. Anytime. Travel Easy™ is the security of knowing that help is an easy phone call away.



Big benefits for new owners - FREE One Year Membership in the Coachmen Owners Association!

Coachmen is proud to sponsor the largest manufacturer sponsored camping club in North America...Coachmen Owners' Association (COA). COA provides you a world of ways to enjoy your RV. This is FUN ON OVERDRIVE and provides: Free Trip Routing, Exciting Tours & Rallies, Free Campground Directory, Local/State Club Activities, Easy RVing Magazine Free, Theme Park Discounts, Fuel Discounts, Free onebigplanet® Memberships with discounts at 180,000 merchants and Much More! Every new Coachmen RV buyer is eligible for a 1 Year FREE membership in the Coachmen Owners' Association. It all adds up to an easy ownership experience!



423 N. Main Street ♦ P.O. Box 30 ♦ Middlebury, IN 46540

To learn more about Coachmen RV and our products and see how Coachmen is making the easy life easier, visit www.coachmenrv.com or call 1.800.353.7383.



Forest River, Inc. encourages our customers to purchase their Forest River products from a local dealership whenever possible for the following reasons:

It is the goal of Forest River, Inc. that all of our RV owners fully enjoy the RV experience and that customer satisfaction meets or exceeds their expectations!

- 1) Forest River, Inc. dealers are independently owned and operated businesses so priority service and scheduling is at their discretion and is often provided to customers that purchased their unit at that dealership.
- 2) Purchasing locally allows customers to establish meaningful relationships with a dealer, enhancing the RV experience through assistance with product questions, user tips or RV regulations for your state or country, and much more!
- 3) Canadian customers must meet requirements to bring an RV purchased out of the country to their home. These requirements may involve additional inspections and certifications, taxes and fees. Your local Canadian Dealer is a professional at meeting these requirements.
- 4) Scheduling timely warranty repairs and adjustments through a local dealership provides far greater flexibility and convenience to you, the customer!



Learn More

Scan this barcode using a QR Reader on your smart phone to learn more about Forest River.



A Berkshire Hathaway company.

GVWR (Gross Vehicle Weight Rating) is the maximum permissible weight of the unit when fully loaded. It includes all weights, inclusive of all fluids, cargo, optional equipment and accessories. For safety and product performance do NOT exceed the GVWR.

GAWR (Gross Axle Weight Rating) is the maximum permissible weight, including cargo, fluids, optional equipment and accessories that can be safely supported by a combination of all axles.

UVW (Unloaded Vehicle Weight)* is the typical weight of the unit as manufactured at the factory. It includes all weight at the unit's axle(s) and tongue or pin and LP Gas. The UVW does not include cargo, fresh potable water, additional optional equipment or dealer installed accessories. *Estimated Average based on standard build optional equipment.

CCC (Cargo Carrying Capacity)** is the amount of weight available for fresh potable water, cargo, additional optional equipment and accessories. CCC is equal to GVWR minus UVW. Available CCC should accommodate fresh potable water (8.3 lbs per gallon). Before filling the fresh water tank, empty the black and gray tanks to provide for more cargo capacity. **Estimated average based on standard build optional equipment.

Each Forest River RV is weighed at the manufacturing facility prior to shipping. A label identifying the unloaded vehicle weight of the actual unit and the cargo carrying capacity is applied to every Forest River RV prior to leaving our facilities.

The load capacity of your unit is designated by weight, not by volume, so you cannot necessarily use all available space when loading your unit.